

PANEL MOUNTING

PANEL THICKNESS:  
0.5-5.0mm [.02-.20in]

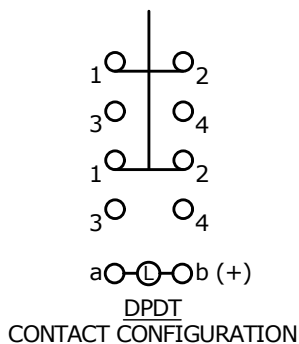

PARTS LIST				
ITEM	QTY	PART NUMBER	DESCRIPTION	
1	1	F040016	D16EER12	
2	1	F050405	50-004-05 28VAC INCANDESCENT LAMP	
3	1	F050112	50-001-12 ROUND FLAT TRANSPARENT GREEN LENS	

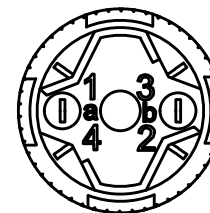
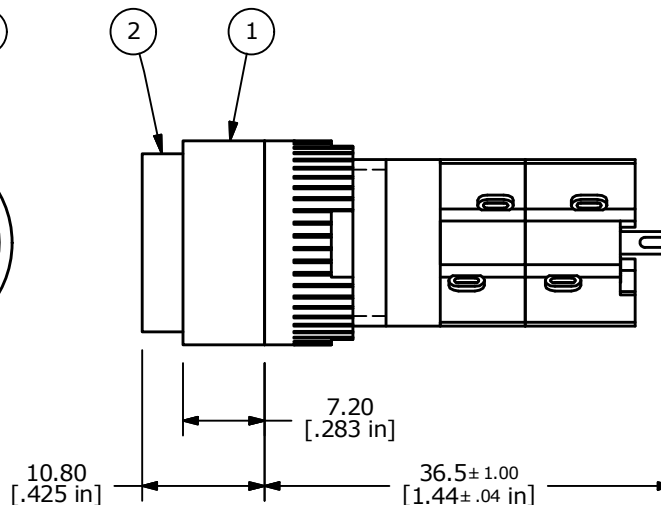
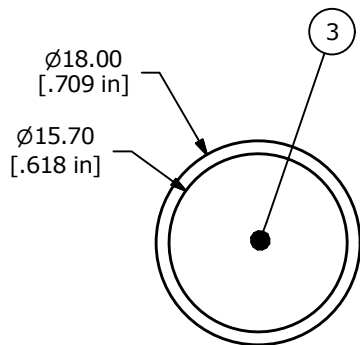
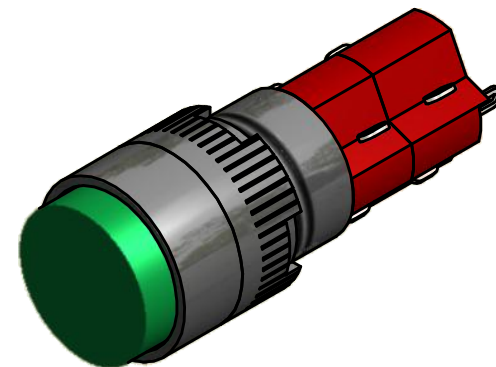

- NOTE:
1. ALL DIMENSIONS IN MM [INCH].
  2. GENERAL TOLERANCE: X.X = ±0.4  
X.XX = ±0.25
  3. TERMINAL NUMBERS FOR REF ONLY.
  - ▲ 4. CONTACT RATING: 5A @ 250VAC  
8A @ 125VAC  
6A @ 24VDC
  5. ELECTRICAL LIFE: 50,000 OPERATIONS
  6. INSULATION RESISTANCE: 1,000 MEGA-OHM MIN.
  7. CONTACT MATERIAL: SILVER PLATED COPPER ALLOY
  - ▲ 8. ACTUATION FORCE: 300g / POLE
  9. OPERATING TEMP.: -25°C to +55°C
  10. ▲ DENOTES CRITICAL PARAMETER.
  11. 2002/95/EC (ROHS) COMPLIANT



A	22167	RELEASED FOR PRODUCTION	2/22/16	MW
REV	PCR NO	DESCRIPTION	DATE	BY

TITLE D16EER12CGRN				
SCALE	DATE	DR	DWG	REV
3:2	2/22/2016	MW	XF0906P	A

THE INFORMATION CONTAINED IN THIS DOCUMENT IS PROPRIETARY TO E-SWITCH AND IS NOT TO BE COPIED OR TRANSFERRED